

"The Wives of Henry VIII" Pendant

As seen in the 2009 Summer Supplement

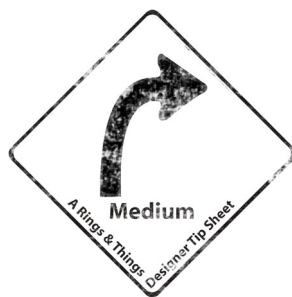

Created by: Amy Mickelson

Suggested Materials:

<u>Qty.</u>	<u>Stock #</u>	<u>Name</u>
8	23-497-362	7mm Czech glass faceted firepolish rotund rondelles, erinite 8467
16	23-494-282	4mm Czech glass faceted firepolish rotund rondelles, amethyst 8439
6	23-444-273	4mm Czech glass faceted firepolish round beads, purple iris 8134
3	37-422-7	2" head pins, antiqued copper plate 12385
118	20-228-224	Size 11 Toho® Japanese glass seed beads, bronze 19941
1	37-136-7	5mm jump ring, antiqued copper plate 12283
1	37-145-7	6mm jump ring, antiqued copper plate 12291
1	44-155-7	28mm square filigree, antiqued copper plater 14114
36"	61-841-50-02	0.008" Beadalon® WildFire™ beading thread, black 20688
16"	40-099-02-7	2.3mm long-and-short figaro chain 12855
2	37-136-7	5mm jump rings, antiqued copper plate (not shown) 12283
1	39-243-7	7x12x4mm lobster clasp, antiqued copper plate (not shown) 12590



Tools: scissors, size 10 beading needle (#65-000-10), chain-nose pliers

To make this design:

1. Thread needle onto a 36" piece of WildFire.
2. String five 4mm firepolish beads. Form a circle and pass the threads through the 5 beads again and secure with a knot. (see figure 1)
3. Add six seed beads, one 7mm rotund bead, and five more seed beads.
4. Pass the needle back through the first seed bead (added in step 3), and through the next 4mm firepolish bead added in step 2. (see figure 2)



Figure 1



Figure 2

5. Repeat steps 3 & 4 four more times.
6. To stiffen this structure, run the thread through all the beads one more time and end with the needle coming out through the first seed bead after the a 7mm rotund bead. (See figure 3)



Figure 3

7. With the same piece of cord, add 1 seed bead, one 4mm rotund bead, 1 seed bead, one 4mm rotund bead, and 1 seed bead and pass through the next 7mm rotund bead.
8. Repeat step 7 four more times to create an outer ring.
9. To secure, and stiffen this structure, run the thread through all the beads of the outer ring one or two more times. (see figure 4)



Figure 4

10. Add a top loop of six additional seed beads above one of the 7mm rotund beads.
11. Run the thread back through the beads in this loop, secure with a knot, and cut excess thread.
12. Use a 6mm jump ring to attach this top loop to one of the corner loops on the filigree.
13. Add beads to three head pins, as shown on front, and attach the two shorter dangles to loops on the filigree before completing the wrapped loops.
14. To secure the bottom, use a 5mm jump ring to attach the long dangle to the bead pendant and filigree.
15. Add this pendant to a 16" piece of chain, and finish with jump rings and a lobster clasp (not shown).

To make nice wire-wrapped beaded head and eye pins:

(For best results, use both chain-nose and round-nose pliers.)

1. Use chain-nose pliers to grasp the wire just above the top of the bead.
2. Use your fingers to bend the wire sharply over the top of the pliers, at a 90° angle. You should have 2-3mm of straight wire between the bead and the bend.
3. Use round-nose pliers to grasp a spot just above the bend, and use your fingers to smoothly bend the wire all the way around the tip of the pliers. (For different sizes of loops, bend the wire around thinner or thicker portions of the pliers' tip.)
4. Now use pliers to grasp the wire firmly across the loop. Use your fingers or chain-nose pliers to carefully wrap the wire around the stem. For best control, experts recommend you break this step into a series of half wraps.
5. Trim excess with flush cutters.

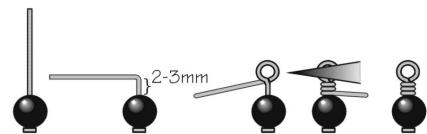

Jump-ring hint:

When you open and close jump rings, twist sideways instead of "ovalling" them. This keeps their shape better, which makes them easier to close all the way.

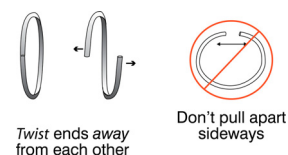

NOTE: This creation is adapted from a design found in *Crystal Beaded Jewellery* by Christine and Sylvie Hooghe.