

# "Twelve Days" Bracelet

As seen in the 2009 Summer Supplement



Created by: Polly LaRue

## Suggested Materials:

<u>Qty.</u>	<u>Stock #</u>	<u>Name</u>
1	49-939-AP	12 days of Christmas charm set, antiqued pewter
2	28-505-986	Beads from India glass assortment, green
1	28-505-985	Beads from India glass assortment, red
3	23-219-107	6x9mm glass teardrop beads, dark topaz
3	23-164-238	Glass "E" beads, ruby/silver-lined
2	23-446-372	6mm round Czech faceted firepolish beads, emerald
1	20-002-3222	Toho® Seed Bead Cocktail™, emerald isle
30	23-205-000	3x5mm three-sided oval glass beads, assorted ( <i>limited stock; see ** for alternate item</i> )
47-50	20-228-141	Size 11 Toho Japanese glass seed beads, white ceylon
18	41-515	4.9mm split rings, sterling silver
9	37-579	1.25" ball-end head pins, sterling silver
2	41-559	2x2mm crimp tubes, sterling silver
1	39-536	6x8mm Mag-Lok® magnetic button clasp, sterling silver
9"	61-813-19-77	0.015" 19-strand Beadalon® stringing cable, silver satin
**	23-444-043	4mm round Czech glass faceted firepolish beads



**Tools:** flush cutters, round-nose pliers, chain-nose pliers, split-ring pliers (#65-930)

## To make this design:

1. Cut a 9" piece of stringing cable.
2. Using the "Techniques for Stringing with Beading Cable" on the back as a guide, string the seed beads and tri-oval (or firepolish) beads in the repeating pattern shown.
3. Add dark topaz, green and red beads plus some seed beads from the cocktail mix, to head pins and make simple loops.
4. Add charm set and bead dangles to bracelet using split rings, in the order pictured.

## To make nice loops on head or eye pins:

1. String selected beads on the head or eye pin.
2. Keep about 8mm (1/3") of wire. Cut off any extra.
3. Use round-nose pliers to grasp the wire just above the bead (at the arrow), and bend sharply away from you.
4. Now use small round-nose pliers to grasp the tip of the wire, and bend it smoothly around the pliers down close to the beads.

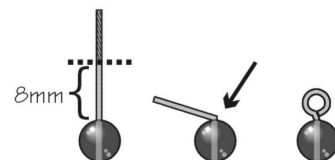

## Techniques for Stringing with Beading Cable

1. Cut wire cable 4" longer than desired necklace or bracelet length. String a crimp bead onto one end of the cable and loop back through crimp bead. Try to tuck excess cable inside your end beads, otherwise trim neatly with flush cutters. Flatten crimp bead with standard round- or flat-nose pliers. Use jump ring to attach one end of your clasp to cable.

**TIP:** When opening and closing jump rings, twist sideways instead of "ovalling" them. This keeps their shape better, which makes them easier to close all the way. (As shown on the left.) To prevent marks on the ring use non-serrated flat-nose pliers.

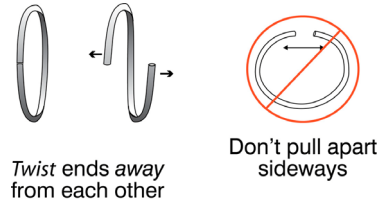

2. String desired pattern.
3. Add final crimp bead; loop cable back through your crimp like in step 1. Tuck excess cable inside end beads, otherwise trim neatly with flush cutters. Flatten crimp bead and attach other end of the clasp with a jump ring.
4. Some designs may require stringing the beads before finishing the cable ends. We recommend using Bead Stoppers™ (#69-144-06 and -16) to secure unfinished ends. When you have finished follow steps 1 and 3.

### Variations:

- a. **Crimping pliers:** To make a nice rounded crimp bead, use the innermost section (1) of the pliers to crimp. Face crimp outward (as shown in example below) and use the outer section (2) of the pliers to round the bead.

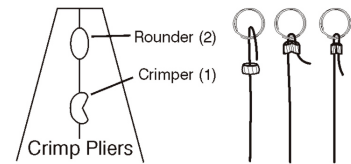

- b. **Crimp covers:** Cover flattened crimps with a crimp cover. Make sure there is enough space around your crimp bead. Use section 2 (see picture above) of the crimping pliers to gently secure the cover over the bead.

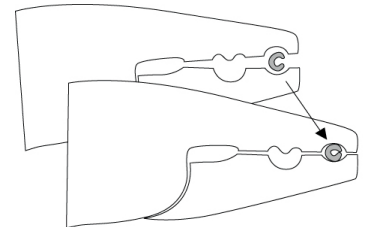

- c. **Bullion:** Cut two pieces in precise equal lengths (approx. 1/2-3/4"), add one crimp tube and one piece of bullion to the end of wire cable. Loop the cable through one portion of clasp and back through the crimp tube. Pull gently until the bullion is flush against the crimp and crimp closed.



- d. **Wire protectors:** Guard wire cable from excessive wear with wire protectors. These are used the same way as bullion.

