

“Think Smashing Thoughts” Necklace & Earrings

As seen in 2009 ad series



Created by: Cindy Morris

This design is made with CRYSTALLIZED™ – Swarovski Elements.

Suggested Materials:

<u>Qty.</u>	<u>Stock #</u>	<u>Name</u>
5	06-401-08-141	CRYSTALLIZED™ 8mm octagon pendants, pacific opal
5	05-000-06-13	CRYSTALLIZED™ 6mm round beads, fuchsia
5	06-301-06-177	CRYSTALLIZED™ 6mm bicone drops, palace green opal
1 pair	34-003-8	TierraCast™ niobium French hook ear wires, copper colored
5	37-422-7	2” head pins, antiqued copper plate
14	37-145-7	6mm round jump rings, antiqued copper plate
16-18”	40-781	2.4mm ball chain, solid copper
1	40-701	2mm ball-chain clasp, solid copper
1x1.5”	64-980-24	24-gauge metal sheet, solid copper



Tools: chain-nose pliers, round-nose pliers, side cutters

To make this design:

1. Use the 24-gauge copper sheet to create a metal stamped pendant using the techniques on the back.
2. Make crystal dangles with jump rings and head pins, using the techniques below.
3. Attach the dangles to the pendant, ball chain and earwires.

Jump-ring hint:

When you open and close jump rings, twist sideways instead of “ovalling” them. This keeps their shape better, which makes them easier to close all the way.

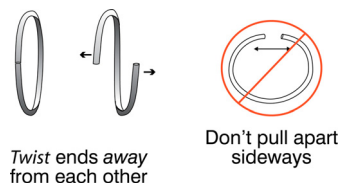

To make nice wire-wrapped beaded head and eye pins:

(For best results, use both chain-nose and round-nose pliers.)

1. Use chain-nose pliers to grasp the wire just above the top of the bead.
2. Use your fingers to bend the wire sharply over the top of the pliers, at a 90° angle. You should have 2-3mm of straight wire between the bead and the bend (less for fine-gauge wire, more for heavy wire or more wraps).
3. Use round-nose pliers to grasp a spot just above the bend, and use your fingers to smoothly bend the wire all the way around the tip of the pliers. (For different sizes of loops, bend the wire around thinner or thicker portions of the pliers' tip.)
4. Now use pliers to grasp the wire firmly across the loop. Use your fingers or chain-nose pliers to carefully wrap the wire around the stem. For best control, experts recommend you break this step into a series of half wraps.
5. Trim excess with flush cutters.

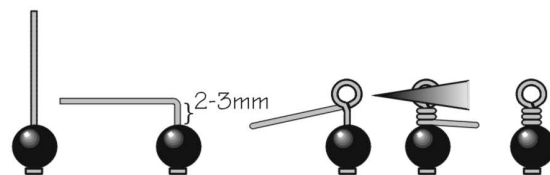

NOTE: Cut the end off one head pin and make a wrapped loop at each end to connect the pendant to the chain.

Techniques for Creating a Stamped Metal Charm

Tools and supplies:

Nylon/steel block, metal snips, chasing hammer, utility hammer, rubber mallet or nylon hammer, 2-hole metal punch, letter stamps, brass brush, 0000 steel wool, metal file, masking tape, ink pad, ruler, oxidizing agent or patina solution

This technique works well for sterling silver, solid copper, and solid brass sheet or “dog tags.” Each metal will have its own unique characteristics, and if possible it is best to practice on a scrap of metal prior to making your actual project.



1. Use your letter stamps with an ink pad and a piece of paper to pre-layout your script. Plan your letter layout and spacing for your metal tag.

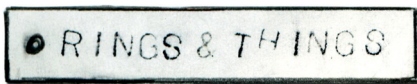

2. Using metal snips, indelible marker and a ruler, cut a piece of 24-gauge sheet metal to the desired size and shape.



3. File the corners and any rough edges and punch hole(s) into tag and flatten.



4. Label one side of your steel block as “rubber” and one side as “steel.” The rubber side is used for flattening with a leather or rubber mallet. The steel side is used for hammering or stamping.

5. On the “steel” side of your steel block, tape your metal tag in place with masking tape. This will hold your tag securely while you stamp, and can act as a guide for letter placement.

6. If your letter stamps do not have a directional mark, place a dot with Wite-out® to indicate the top side of each letter. This will aid in keeping all of your letters directionally correct. Use your stamped paper guide to plan the position of the first letter on your tag.

7. Line up the first stamp. In a standing position, hold the stamp perpendicular to the metal tag. With a utility hammer, strike the stamp firmly just once, straight down with one hard hammer blow. Repeat for each letter until your word or phrase is complete.



8. If desired, add texture to your piece, such as hammering. Remember the antique patina will enhance any indentations on the metal.



9. After you have stamped and textured your tag, finish the edges by using the peening edge of a chasing hammer to lightly dapple all around the edges of the tag. File any rough points.

10. Dip tag and findings (split/jump rings, head/eye pins, etc.) into the oxidizing agent or patina solution. Once desired patina has been achieved, rinse in cool water and dry. Use 0000 steel wool and brass brush to clean your piece.



11. Assemble into finished jewelry piece.

Tip: Have fun, and don't expect perfection; little oddities will give your tag charm and uniqueness. For additional decoration try adding design stamps, or metal forms you create yourself using 14-gauge stainless steel wire (available at hardware stores).