

"Key to the City" Necklace

As seen in the 2009 Summer Supplement



Created by: Mollie Valente

Suggested Materials:

<u>Qty.</u>	<u>Stock #</u>	<u>Name</u>
1	44-455-0	17x7mm brass key charm, raw brass
1	46-301-11-0	22mm round bezel cup with loop, brass
15"	40-099-13-6	2.1mm cable chain, antiqued brass plate
3"	40-099-08-6	2.8mm curb chain, antiqued brass plate
3	37-101-9	3mm round jump rings, gunmetal
1	37-136-6	5mm round jump ring, antiqued brass plate
1	21-000-079-56	8mm puffed-coin gemstone bead, green tourmalinated quartz
1	37-415-6	1.5" thin head pin, antiqued brass plate
1	39-343-6	12mm lobster clasp, antiqued brass plate
1		Artisan-made polymer-clay cabochon to fit bezel cup



Tools and supplies: Paisley texture stamp (#87-057-09), Eurotool® pro-design shaper set (#87-059), 2-part epoxy adhesive (#60-230), oxidizing solution such as Win-Ox™ (#86-343) or liver of sulfur (#86-354), chain-nose pliers, flat-nose pliers, round-nose pliers, side cutters, terra cotta color Sculpey® clay, acrylic paint (white, green, and copper metallic), Jax Green Patina (available from Dick Blick Art Materials® - dickblick.com)

To make this design:

1. Condition the polymer clay and roll flat to just over 1/8" thick.
2. Roll the clay onto the texture plate of your choice.
3. Use the shaper set to cut the clay to the desired size and shape.
4. Patina the key charm with Jax Green Patina or follow the patina methods described in *The Complete MetalSmith* by Tim McCreight (#62-010).
5. Press the key charm into the clay deep enough for the key to stay in the clay.
6. Bake the clay per manufacturer's instructions.
7. Once cooled, create a faux patina with acrylic paint if desired.
8. Patina the bezel cup with liver of sulfur or Win-Ox.
9. Glue the polymer cabochon in the bezel cup with 2-part epoxy, following the manufacturer's instructions.
10. Add the 5mm jump ring to the bezel cup. (See the jump-ring hint on the back.)
11. Cut a 15" piece of cable chain and add a lobster clasp to one end using a jump ring.

Make any necklace adjustable in length by creating your own necklace adjuster.

12. Cut a 3" piece of 2.8mm curb chain.
13. Add a gemstone bead to a head pin and make a wrapped loop. (See the technique for making wrapped loops on the back.)
14. Attach this dangle to one end of the chain with a jump ring.
15. Use a jump ring to attach the other end of this short extender to the main necklace chain.
16. Attach the polymer pendant to the necklace.

TIP: The 2.8mm curb chain is large enough to fit the 12mm lobster clasp without additional jump rings.

Jump-ring hint:

When you open and close jump rings, twist sideways instead of “ovalling” them. This keeps their shape better, which makes them easier to close all the way.

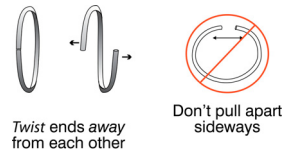

To make nice wire-wrapped beaded head and eye pins:

(For best results, use both chain-nose and round-nose pliers.)

1. Use chain-nose pliers to grasp the wire just above the top of the bead.
2. Use your fingers to bend the wire sharply over the top of the pliers, at a 90° angle. You should have 2-3mm of straight wire between the bead and the bend (less for fine-gauge wire, more for heavy wire or more wraps).
3. Use round-nose pliers to grasp a spot just above the bend, and use your fingers to smoothly bend the wire all the way around the tip of the pliers. (For different sizes of loops, bend the wire around thinner or thicker portions of the pliers' tip.)
4. Now use pliers to grasp the wire firmly across the loop. Use your fingers or chain-nose pliers to carefully wrap the wire around the stem. For best control, experts recommend you break this step into a series of half wraps.
5. Trim excess with flush cutters.

