

"Green Wave" Necklace

As seen in the 2009 Spring Supplement



Created by: Mollie Valente

Suggested Materials:

<u>Qty.</u>	<u>Stock #</u>	<u>Name</u>
1	56-034-7	1½" TierraCast™ bead bar, antiqued copper
2	43-138-7	10mm TierraCast Hammertone large-hole bead caps, antiqued copper
1	41-848-AC	TierraCast decorative necklace bail, antiqued copper
1	49-947-13-AC	3-D seahorse charm, antiqued copper
1	05-301-06-70	6mm Swarovski® crystal bicone, chrysolite
1	05-301-04-170	4mm Swarovski crystal bicone, moonlight
18	21-886-023-S	6mm round gemstone beads, manmade malachite
4	26-812-006	9x8mm rondelle beads with fluted pattern and collar, antiqued copper
28	26-814-02	2mm round beads, copper
1	37-422-7	2" standard head pin, antiqued copper
2	49-947-44-7	13mm TierraCast Hammertone round links, antiqued copper
10	37-145-7	6mm round jump rings, antiqued copper
4	37-136-7	5mm round jump rings, antiqued copper
8"	61-723-19-54	0.018" 19-strand Beadalon® stringing cable, copper satin
16"	40-099-08-7	2.8mm curb chain, antiqued copper
2	41-050-8	Wire Guardians™ wire protectors, copper plate
2	41-252-8	2mm crimp tubes, copper
1	39-243-7	7x12x4mm lobster clasp, antiqued copper
1		Artisan-made glass bead with 3/32"+ hole

Tools: side cutters, flat-nose pliers, chain-nose pliers, round-nose pliers, crimping pliers



To make this design:

1. Add bead caps and artisan-made glass bead to bead bar.
2. Add crystal bicones and two 2mm beads to a head pin and make a wrapped loop.
3. Use 5mm jump rings to attach glass bead pendant, bicone dangle and seahorse charm to the bail, as pictured.
4. Cut an 8" piece of stringing cable, and add the malachite and copper beads in the symmetrical pattern pictured.
5. At the halfway point, string four 2mm copper beads onto the cable and slide on the bail. (These beads are hidden under the bail in the picture.) Repeat the malachite and copper bead pattern
6. Finish both ends with crimp tubes and wire protectors.
7. Use two 6mm jump rings to attach the round hammered links on each end of the malachite and copper strand.
8. Cut four 4" pieces of chain and attach two 6mm jump rings to one end of each piece of chain and to the 13mm links.
9. Attach one 6mm jump ring to the other end of each piece of chain, and to the lobster clasp.

TIP: For extra security, glue the bead caps onto the glass bead using an adhesive such as Epoxy 330(#60-230)

TIP: Using chain for a portion of a necklace is a great way to cut costs without compromising quality! Or create a different look by altering the length of chain.

TIP: The wire protectors ensure the stringing cable won't slip through the jump rings.

To make nice wire-wrapped beaded head and eye pins:

(For best results, use both chain-nose and round-nose pliers.)

1. Use chain-nose pliers to grasp the wire just above the top of the bead.
2. Use your fingers to bend the wire sharply over the top of the pliers, at a 90° angle. You should have 2-3mm of straight wire between the bead and the bend (less for fine-gauge wire, more for heavy wire or more wraps).
3. Use round-nose pliers to grasp a spot just above the bend, and use your fingers to smoothly bend the wire all the way around the tip of the pliers. (For different sizes of loops, bend the wire around thinner or thicker portions of the pliers' tip.)
4. Now use pliers to grasp the wire firmly across the loop. Use your fingers or chain-nose pliers to carefully wrap the wire around the stem. For best control, experts recommend you break this step into a series of half wraps.
5. Trim excess with flush cutters.

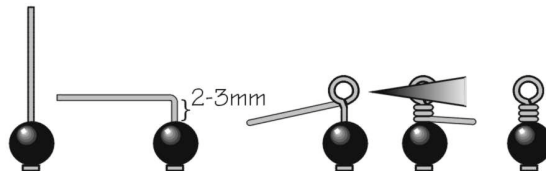

Jump-ring hint:

When you open and close jump rings, twist sideways instead of "ovalling" them. This keeps their shape better, which makes them easier to close all the way.

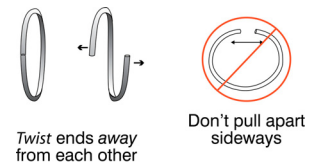

How to cut pieces of chain all the same length:

1. Cut one piece of chain to the required length, and slide a head pin through the end link.
2. Slide the end link of the spooled chain onto this head pin.
3. Hold the head pin up horizontally with the two chains dangling down vertically.
4. Cut the chain from the spool, the same length as the piece already cut.
5. Repeat steps 2-4 for the total number of pieces you need.