

"Ballroom Glitz" Earrings

As seen in the 2009 Summer Supplement



Created by: Evette Rana

This design is made with CRYSTALLIZED™ – Swarovski Elements.

Suggested Materials:

<u>Qty.</u>	<u>Stock #</u>	<u>Name</u>
2	05-139-12-150	CRYSTALLIZED™ 12.5mm crystal ring beads, crystal/golden shadow
10	05-020-06-150	CRYSTALLIZED™ 6mm helix beads, crystal/golden shadow
2	44-100-4	30x24mm domed round filigrees, gold plate
5½"	40-099-17-4	2.9mm flat link chain with figure-8 connectors, gold plate
14	37-101-2	3mm round jump rings, yellow
10	37-421-2	7/8" standard head pins, yellow
2	37-422-2	2" standard head pins, yellow
2	34-323-4	French hook ear wires, yellow



Tools: flush cutters, round-nose pliers, chain-nose pliers

To make this design:

1. Cut the chain into the following lengths: four 3/8" pieces, four 1/2" pieces and two 1" pieces.
2. Add the crystal ring beads to the 2" head pins, make simple loops and attach these to the top loop of the filigrees.
3. Add the helix beads to the 7/8" head pins, and make simple loops.
4. Attach these crystal dangles to the pieces of chain, as pictured. Connect them to the five bottom loops on the filigrees using jump rings.
5. Use jump rings to attach the ear wires to the top loop on the filigrees.

To make nice loops on head or eye pins:

1. String selected beads on the head or eye pin.
2. Keep about 8mm (1/3") of wire. Cut off any extra.
3. Use round-nose pliers to grasp the wire just above the bead (at the arrow), and bend sharply away from you.
4. Now use small round-nose pliers to grasp the tip of the wire, and bend it smoothly around the pliers down close to the beads.

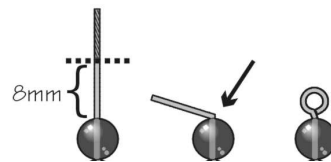

Jump-ring hint:

When you open and close jump rings, twist sideways instead of "ovalling" them. This keeps their shape better, which makes them easier to close all the way.

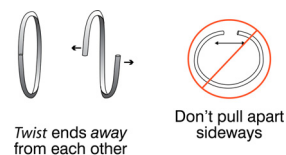

HINT: How to cut pieces of chain all the same length.

1. Cut one piece of chain to the required length, and slide a head pin through the end link.
2. Slide the end link of the spooled chain onto this head pin.
3. Hold the head pin up horizontally with the two chains dangling down vertically.
4. Cut the chain from the spool, the same length as the piece already cut.
5. Repeat steps 2-4 for the total number of pieces you need.