

# "Woodland" Bracelet

As seen in the Rings & Things Wholesale Catalog 2009-10



Created by: Mollie Valente



## Suggested Materials:

<u>Qty.</u>	<u>Stock #</u>	<u>Name</u>
7	03-700-08-06	8mm Swarovski® crystal margarita beads, crystal/vitrail medium
2	03-700-06-08	6mm Swarovski crystal margarita beads, amethyst
2	03-700-06-15	6mm Swarovski crystal margarita beads, peridot
3	03-700-06-22	6mm Swarovski crystal margarita beads, topaz
2	05-301-04-22	4mm Swarovski crystal bicones, topaz
16"	47-402-SP	14-gauge round wire, copper
15	37-067-22	2" thin head pins, copper
6"	40-099-07-7	4.5mm rollo chain, antiqued copper
1	39-243-7	7x12x4mm lobster clasp, antiqued copper
1	37-136-7	5mm round jump ring, antiqued copper
1	26-813-118	6mm Bali-style flower bead with rope edge, antiqued copper

**Tools:** round-nose pliers, chain-nose pliers, flat-nose pliers, side flush cutter, chasing hammer, steel block, metal file, mandrel (made from a 2" straight piece of 14-gauge wire), antiquing solution such as liver of sulfur (#86-354) or Win-Ox™ (#86-343)

## To make this design:

1. Cut the 14-gauge wire into seven 2¼" pieces and file one end of each piece smooth.
2. Use round-nose pliers to form a spiral link (filed end in the center of the spiral). Cut any excess off the tail of each link and file the tail end smooth.
3. Gently texture each spiral link with the broad head of the chasing hammer.
4. Antique the head pins and copper wire spirals with liver of sulfur (#86-354) or Win-Ox™ (#86-343).
5. Add one margarita crystal bead to each oxidized head pin.
6. Using a 2" straight piece of 14-gauge wire as a mandrel, coil the head pin tightly around the mandrel as many times as it will wrap and slide off.
7. Repeat step 6 with the remaining margarita crystals and head pins.
8. Cut the chain into the following lengths:
  - one 2¼" piece (for the dangle-adjuster-end chain),
  - one ¾" piece (for the clasp-end chain),
  - and 6 pieces consisting of exactly 3 links (for in between the spirals).

9. Slide a 6mm margarita coil (bead end first) onto a spiral link and position it midway around the spiral (these are tight and may require a bit of effort to slide).
10. To the same spiral, add a 3-link chain length, and an 8mm margarita coil (coil end first).
11. Repeat steps 9 and 10 for all the spirals.
12. Attach the 2¼" piece of chain to the first end spiral, and the ¾" piece to the final spiral link.
13. Connect the spirals by sliding the unattached end of the 3-link chain onto the inside spiral of each link. This can also be achieved by opening and closing the chain links.
14. Attach the lobster clasp to the ¾"end chain using a jump ring
15. Add the crystal bicones and copper bead to a head pin, make a wrapped loop and attach to the 2¼" adjuster chain end.

**Jump-ring hint:**

When you open and close jump rings, twist sideways instead of “ovalling” them. This keeps their shape better, which makes them easier to close all the way.

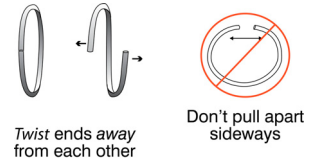

**To make nice wire-wrapped beaded head and eye pins:**

(For best results, use both chain-nose and round-nose pliers.)

1. Use chain-nose pliers to grasp the wire just above the top of the bead.
2. Use your fingers to bend the wire sharply over the top of the pliers, at a 90° angle. You should have 2-3mm of straight wire between the bead and the bend (less for fine-gauge wire, more for heavy wire or more wraps).
3. Use round-nose pliers to grasp a spot just above the bend, and use your fingers to smoothly bend the wire all the way around the tip of the pliers. (For different sizes of loops, bend the wire around thinner or thicker portions of the pliers' tip.)
4. Now use pliers to grasp the wire firmly across the loop. Use your fingers or chain-nose pliers to carefully wrap the wire around the stem. For best control, experts recommend you break this step into a series of half wraps.
5. Trim excess with flush cutters.

